

Polymer concrete grate

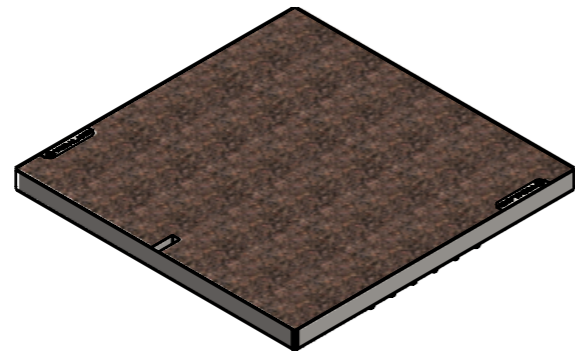
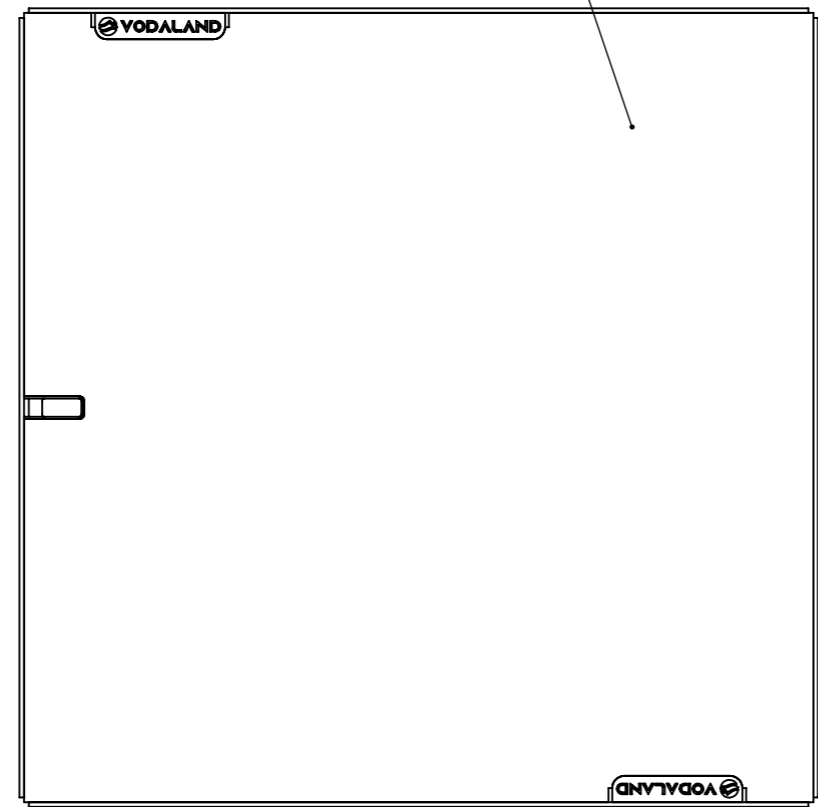

1. Dimensions for reference, inch [mm]
2. Delivery and packaging are carried out in accordance with the terms of the contract
3. The manufacturer reserves the right, without notice to the consumer, to make changes to the design of the products for improvement of their technological and operational parameters, which will not affect the quality and properties of the product
4. Deviation of the actual weight of the nominal can be up to 10%.

UNLESS OTHERWISE SPECIFIED: DIMENSIONS ARE IN MILLIMETERS SURFACE FINISH: TOLERANCES: ISO 2768 - c/LISO 2768 - c LINEAR: ANGULAR:			FINISH:		DEBURR AND BREAK SHARP EDGES		DO NOT SCALE DRAWING		REVISION			
							TITLE: 20"x20" Polymer Concrete Grate Base with stainless steel frame A15 Dark					
							ARTICLE: 35791-Dark				A3	
							WEIGHT: 60.41 lb / 27.40 kg		SCALE: 1:5		SHEET 1 OF 1	
DRAWN		NAME		SIGNATURE		DATE						
		Dyka				18.11.2024						
CHK'D		Kyselytsia										
APPV'D		I. Malynovskiy										
MFG												
Q.A												